

THIS INFORMATION IS CONFIDENTIAL AND IS DISCLOSED TO YOU ON CONDITION THAT NO FURTHER DISCLOSURE IS MADE BY YOU TO OTHER THAN TOP-LINK PERSONNEL WITHOUT WRITTEN AUTHORIZATION FROM TOP-LINK LTD.

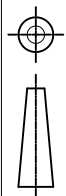

DWG NO. C200050

USED ON

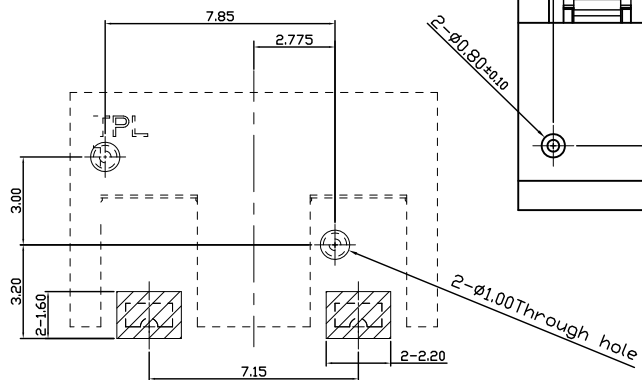
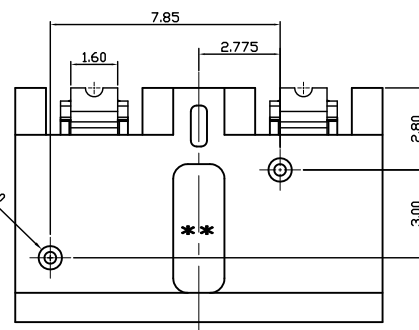
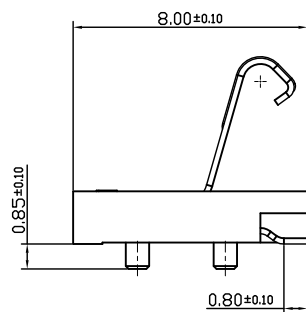
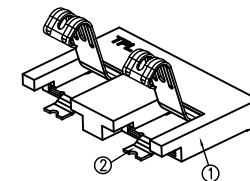
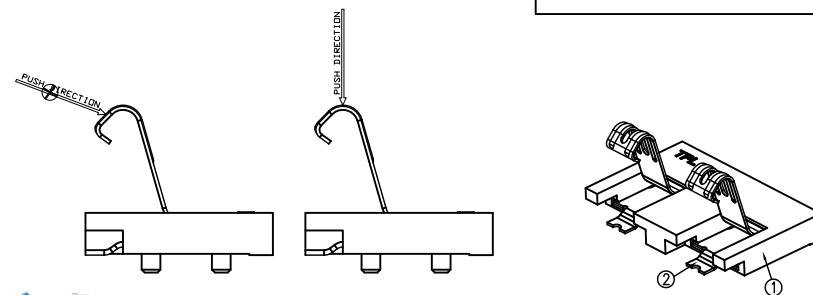
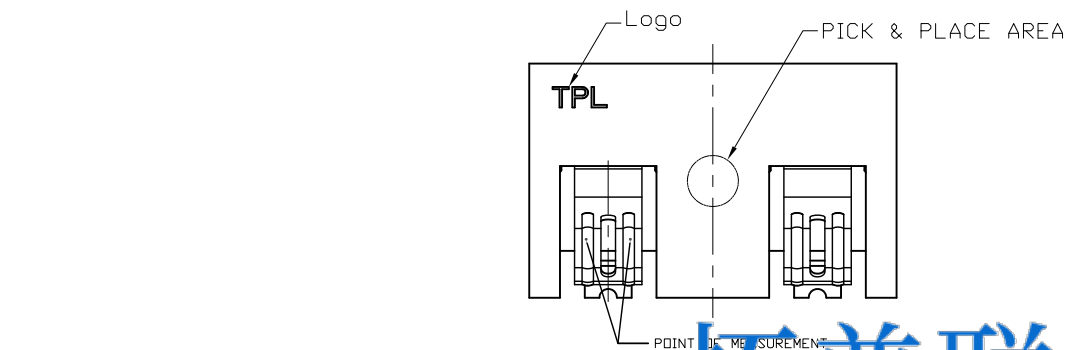

RECOMMEND PCB LAYOUT
TOLERANCE=±0.05

NOTES:

1. SPECIFICATION:

1.1 ELECTRICAL CHARACTERISTICS:

VOLTAGE RATING : 200V AC/DC

CURRENT RATING:3.0A

LOW LEVEL CONTACT RESISTANCE:50mΩ Max.

1.2 MECHANICAL CHARACTERISTICS:

CONTACT NORMAL FORCE:250gf MIN PER PIN AT

WORKING POSITION

DURABILITY : MATED 5,000 CYCLES AT WORKING STROKE

WITHOUT DEGRADING

1.3 ENVIRONMENTAL CHARACTERISTICS:

OPERATING TEMPERATURE RANGE : -20°C TO +70°C.

2. TAPE & REEL PACKAGING PER EIA481 STANDARD.

3. DIMENSION SHALL BE INTERPRETED PER ASME Y14.5M-2009.

4. HARMFUL MATERIAL CONTROL FOLLOW "RoHS"

LOC
-
DIST
-

LTR	REVISION RECORD	APVD	DATE

ITEM	PART NAME	QTY	DESCRIPTION
3	CARRIER TAPE	12mm	TRANSPARENCY
2	CONTACT	2	COPPER ALLOY,Contact area:10u"Min,Au:1u"Min Over all.
1	HOUSING	1	HIGH TEMPERATURE THERMAL PLASTIC

DIMENSIONS IN MM
TOLERANCES UNLESS
OTHER SPECIFIED
0 = ±
0.0 = ±0.15
0.00 = ±0.10

ANGLE:
0 = ±3°
0.0 = ±2°

REMOVE BURRS. BREAK
SHARP EDGES R0.10 MAX
DO NOT SCALE PRINT

MATL	HT TR	FIN
DWN	APVD	CHK
REL	REL	REL
NAME	CUSTOMER DRAWING FOR 6. 4H 2PIN BATTERY	
SCALE	A4	DWG NO.
1:1	C200050	SHEET 1 OF 1
REV	A	

Top-Link
Electronics
Top-Link
Electronics Ltd.